

LED Reflector
LD SSL 15W Pro - Specification Sheet

Product model:	LD-SSL-15W-Pro
Wattage:	15W
Lumen:	1600LM
LED Type:	SMD 2835*40pcs
Solar Panel:	Mono-crystalline silicon (9.5Wp)
Battery:	5400mAh/7.4V Lithium battery (Capacity max 10800mAh/3.7V)
Charging time:	6Hrs/Day
Dimension(mm):	492.5*231.9*58mm
PIR Sensor range:	Angle 120°, Detection area 3-8M
Beam angle:	140x70° - TPIII
IP Class:	IP 65
Surface Color:	Black
Housing Material:	ABS+PC
Working Temp:	-15C° - 50C°
Warranty:	24 months (battery warranty 12 months)



 Black

Installation

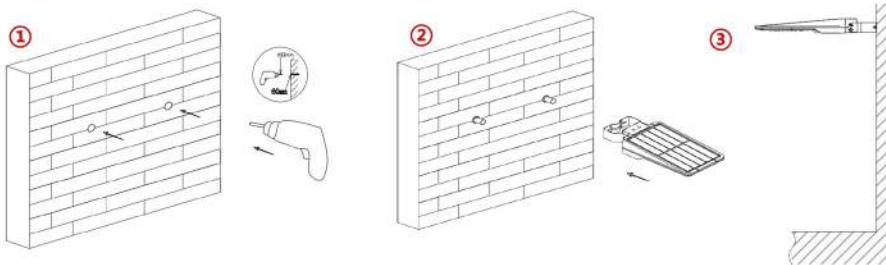

1. Prepare lamp, accessories and tool well firstly.
2. Drill two holes of $\Phi 8\text{mm}$ with a depth of 60mm on the wall. (Picture ①)
3. Fix the expansion screws into the holes. (Picture ②)
4. Then use a wrench to fix the lamp on the wall with expansion screws. (Picture ③)

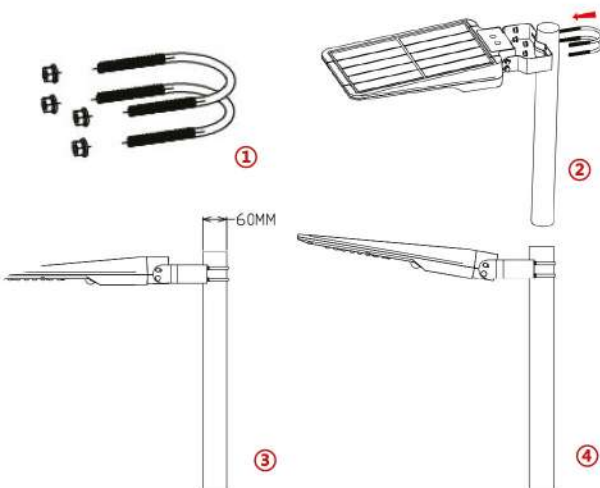

1. Prepare lamp, accessories and tools well firstly.
2. Remove the nut spacer of U-shaped bracket. (Picture ①)
3. Use the U-shaped bracket to fix the lamp on the pole. (Picture ②)
4. Loosen the screws at both ends of the bracket and adjust the angle of the lamp as needed, which is 20° adjustable in clockwise direction and 10° adjustable in counterclockwise direction, then tighten the screws (Picture ③ ④)

Size drawing

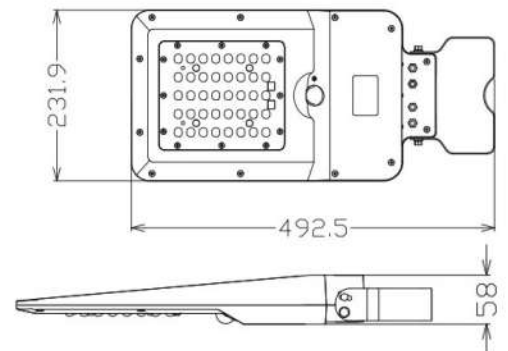

Installation

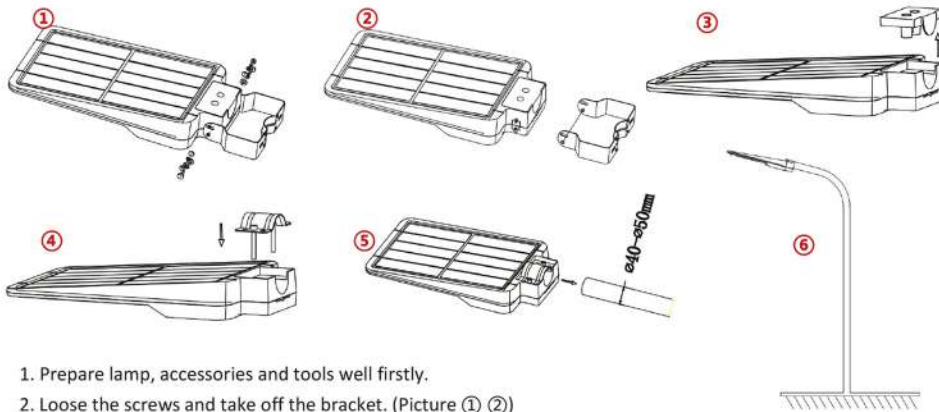

1. Prepare lamp, accessories and tools well firstly.
2. Loose the screws and take off the bracket. (Picture ① ②)
3. Move the cover of lamp socket. (Picture ③)
4. Fix the arch-shaped bracket onto the lamp socket (do not lock first). (Picture ④)
5. Set up the lamp onto the lamp pole. (Picture ⑤)
6. Adjust the lamp and balance it, then lock the arch-shaped bracket. (Picture ⑥)

Working modes

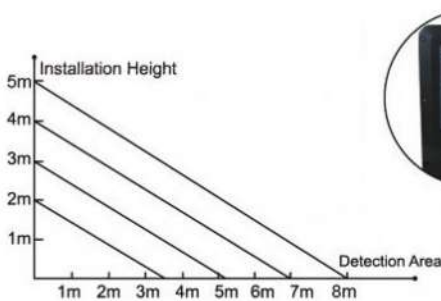

ON/OFF

This lamp is with auto-adjusting working mode, you only need to press the button once, it will work permanently.

First 5 Hrs lighting mode:

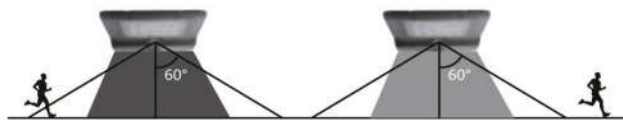

Automatically turns on to full brightness when motion is detected in the range ≤ 8 mtrs and then turns to weak brightness in 20 seconds of no motion.

After 5 Hrs lighting or battery capacity below 30%:



Automatically turns on to full brightness when motion is detected in the range ≤ 8 mtrs, then turns to weak brightness in 20 seconds of no motion, and then turns off after 5 minutes.

Features & Advantages

- Unique patent design, slim , smart, durable, easy Install.
- Patented smart working modes , smart & longer lighting time .
- 3 optional installation: ① wall mounted ② straight pole installation ③ curved pole installation.
- Professional optical lens , wide lighting area and more brightness.
- SMD2835 chips high lumen & long daily use time by 18650 lithium battery stocking power , capacity 10800mAh .
- High quality mono-crystalline silicon solar panel, high efficiency conversion solar power to electricity.
- Tilt down 5 degree design , better to get sunshine , helpful for solar panel clean and water drainage at rainy days.
- The lamp can be flexibly 20° adjustable in clockwise direction and 10° adjustable in counterclockwise direction, you can easily adjust it to best angle for solar charging.
- Scientific human induction design, wide angle detection, makes the body movement detection in large angle and longer distance.

Cautions

1. This is a solar powered lamp, please install it in a location where can get enough sunshine.
2. Please note the lighting time depends on the sunshine duration & weather.
3. Built-in intelligent IC is with over-charge, over-discharge and over-voltage protection.
4. The lamps get solar charged at day time, and light up automatically at dusk.
5. The lamp is equipped with an internal battery pack, which is replaceable. If any need, please contact seller for correct new battery pack.
6. If the battery is taken out and put back in or replaced with new ones, please toward the solar panel to sunshine or a strong light to activate the lamp.
7. Non-professionals please do not disassemble the lamp.
8. Please do not dispose the battery with household garbage to avoid explosion.

Application

